

Switchmode Schottky Barrier Power Rectifiers

Using the Schottky Barrier principle with high temperature operation metal. The proprietary barrier technology allows for reliable operation up to 150°C junction temperature. Typical applications are in switching Mode Power Supplies such as adaptors, Photovoltaic Solar cell protection, free-wheeling and polarity protection diodes.

Features

- * Ultra Low Forward Voltage.
- * Low Switching noise.
- * High Current Capacity
- * Low Power Loss & High efficiency.
- * High Operating Junction Temperature
- * Low Stored Charge Majority Carrier Conduction.
- * Plastic Material used Carries Underwriters Laboratory Flammability Classification 94V-O
- * Pb free
- * In compliance with EU RoHs directives

**SCHOTTKY BARRIER
RECTIFIERS**

**60 AMPERES
60 VOLTS**

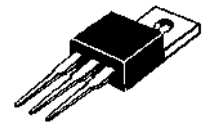

TO-220AB

MAXIMUM RATINGS

Characteristic	Symbol	S60M60C	Unit
Peak Repetitive Reverse Voltage Working Peak Reverse Voltage DC Blocking Voltage	V_{RRM} V_{RWM} V_R	60	V
RMS Reverse Voltage	$V_{R(RMS)}$	42	V
Average Rectifier Forward Current (per diode) Total Device (Rated V_R)	$I_{F(AV)}$	30 60	A
Peak Repetitive Forward Current (Rate V_R , Square Wave, 20kHz)	I_{FM}	60	A
Non-Repetitive Peak Surge Current (Surge applied at rate load conditions half-wave, single phase, 60Hz)	I_{FSM}	350	A
Operating and Storage Junction Temperature Range	T_J, T_{stg}	-65 to +150	°C

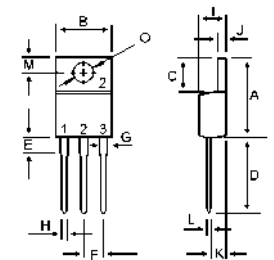

DIM	MILLIMETERS	
	MIN	MAX
A	14.68	16.00
B	9.78	10.42
C	5.02	6.60
D	13.00	14.62
E	3.10	4.19
F	2.41	2.67
G	1.10	1.67
H	0.69	1.01
I	4.22	4.98
J	1.14	1.40
K	2.20	3.30
L	0.28	0.61
M	2.48	3.00
O	3.50	4.00

THERMAL RESISTANCES

Typical Thermal Resistance junction to case	$R_{\theta jc}$	8.8	°C/w
---	-----------------	-----	------

ELECTRICAL CHARACTERISTICS

Characteristic	Symbol	Min.	Typ.	Max.	Unit
Maximum Instantaneous Forward Voltage ($I_F = 30$ Amp $T_C = 25^\circ\text{C}$) ($I_F = 30$ Amp $T_C = 125^\circ\text{C}$)	V_F	---	0.58 0.60	0.65 ---	V
Maximum Instantaneous Reverse Current (Rated DC Voltage, $T_C = 25^\circ\text{C}$) (Rated DC Voltage, $T_C = 125^\circ\text{C}$)	I_R	---	0.12 40	0.30 ---	mA

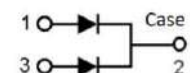

FIG-1 FORWARD CURRENT DERATING CURVE

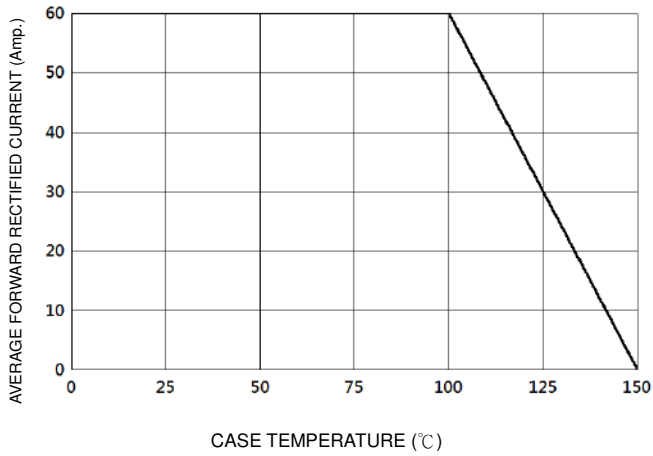

FIG-2 TYPICAL FORWARD CHARACTERISTICS

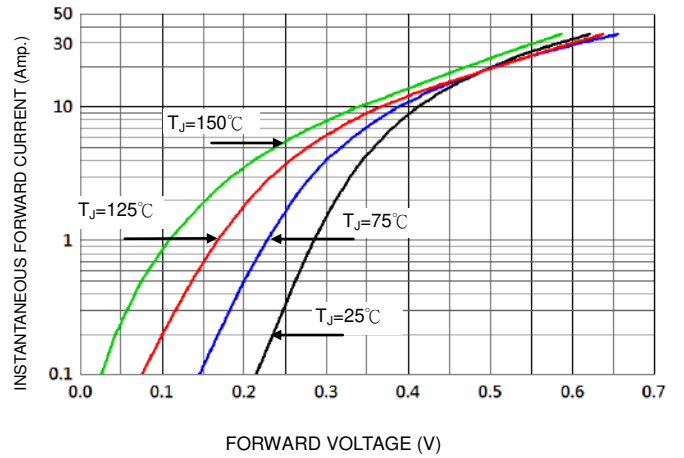

FIG-3 TYPICAL REVERSE CHARACTERISTICS

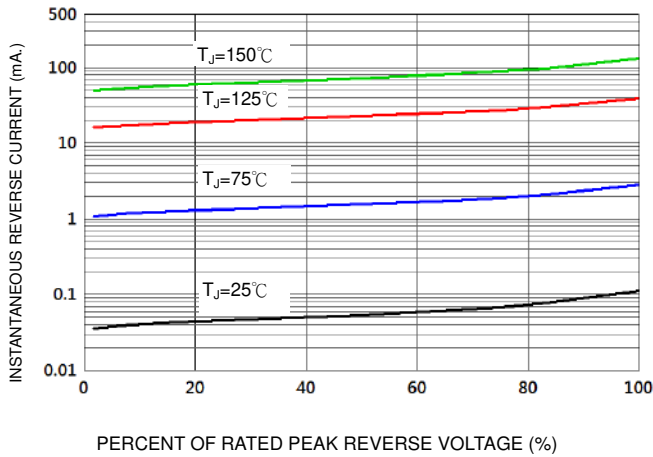

FIG-4 TYPICAL JUNCTION CAPACITANCE

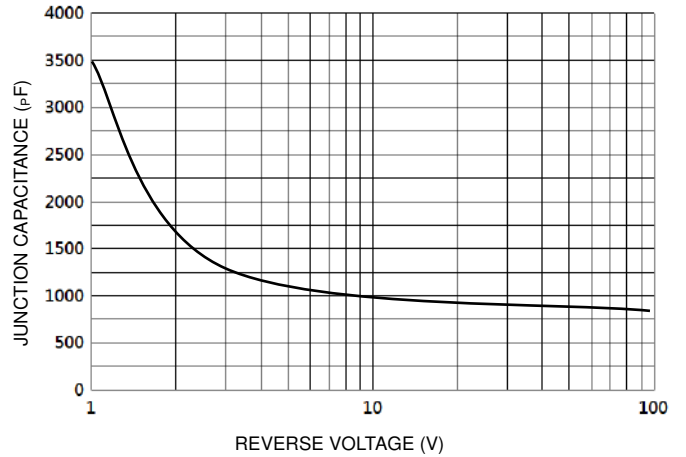

FIG-5 PEAK FORWARD SURGE CURRENT

